

# City of Madison Bus Rapid Transit

ITS Wisconsin Conference

October 27, 2022

Michael Schneider, PE  
Michael.Schneider2@aecom.com

Chris Lynch, PE  
Chris.Lynch@Strand.com

# City of Madison BRT

Madison Bus Rapid Transit Overview

Org Chart

Routes/Running Way & Stations

Station Locations

Western Segment (Mineral Point, Whitney Way, Sheboygan, University Ave)

Eastern Segment (Downtown & East Washington)

Traffic Components

Peak Hour Bus Lane

Left Turn Lanes

Communications (Transit Signal Priority)

# City of Madison BRT

Madison Bus Rapid Transit Overview

Org Chart

Routes/Running Way & Stations

Station Locations

Western Segment (Mineral Point, Whitney Way, Sheboygan, University Ave)

Eastern Segment (Downtown & East Washington)

Traffic Components

Peak Hour Bus Lane

Left Turn Lanes

Communications (Transit Signal Priority)

# Project Team – over 100 staff assisting with project





# Overview of BRT – high quality, cost-effective transit system

- Direct routes and fewer stops
- Improved boarding
- Bus-only lanes
- Transit signal priority



# City of Madison BRT Routes – connecting key corridors

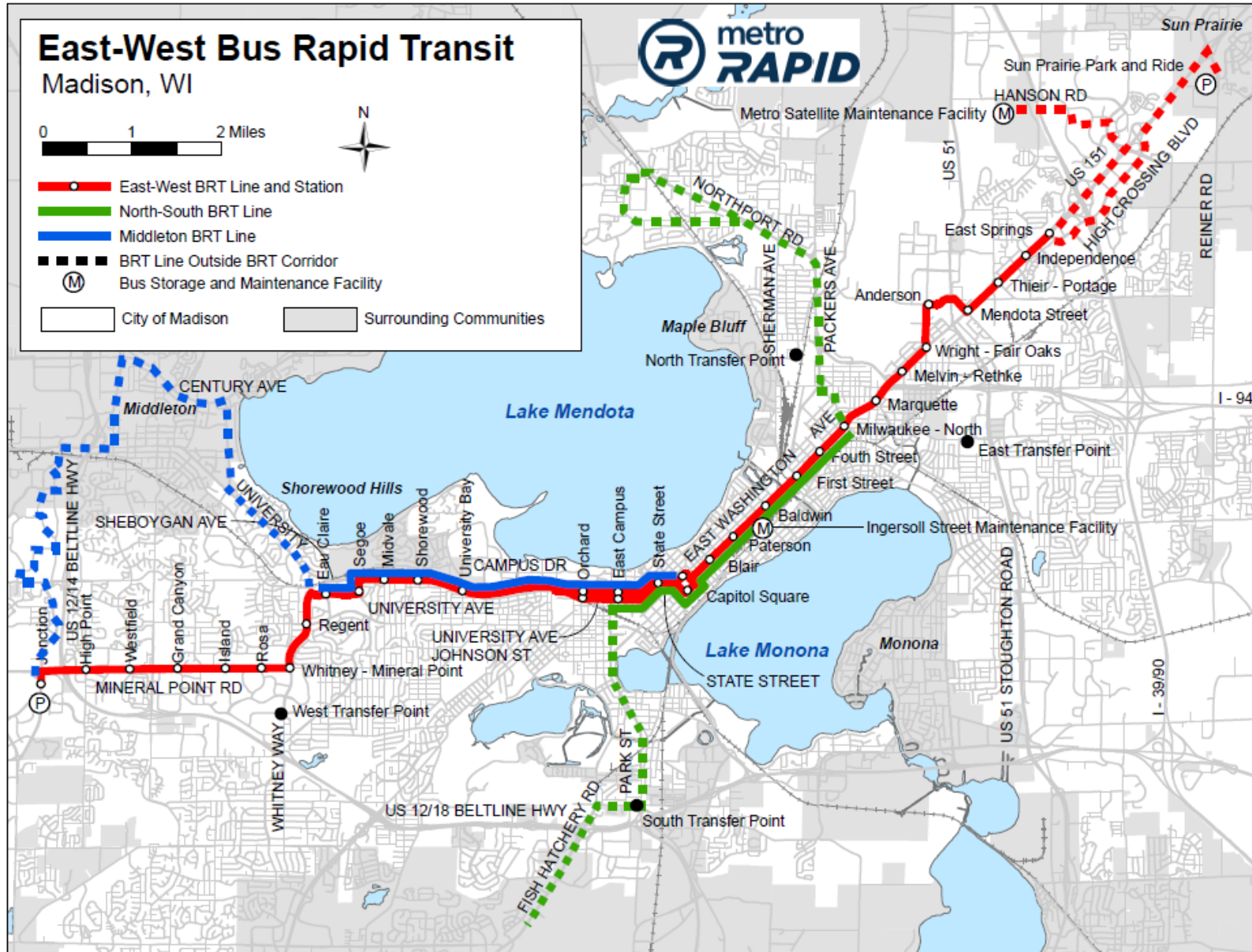



# City of Madison BRT Running Way – majority dedicated lane

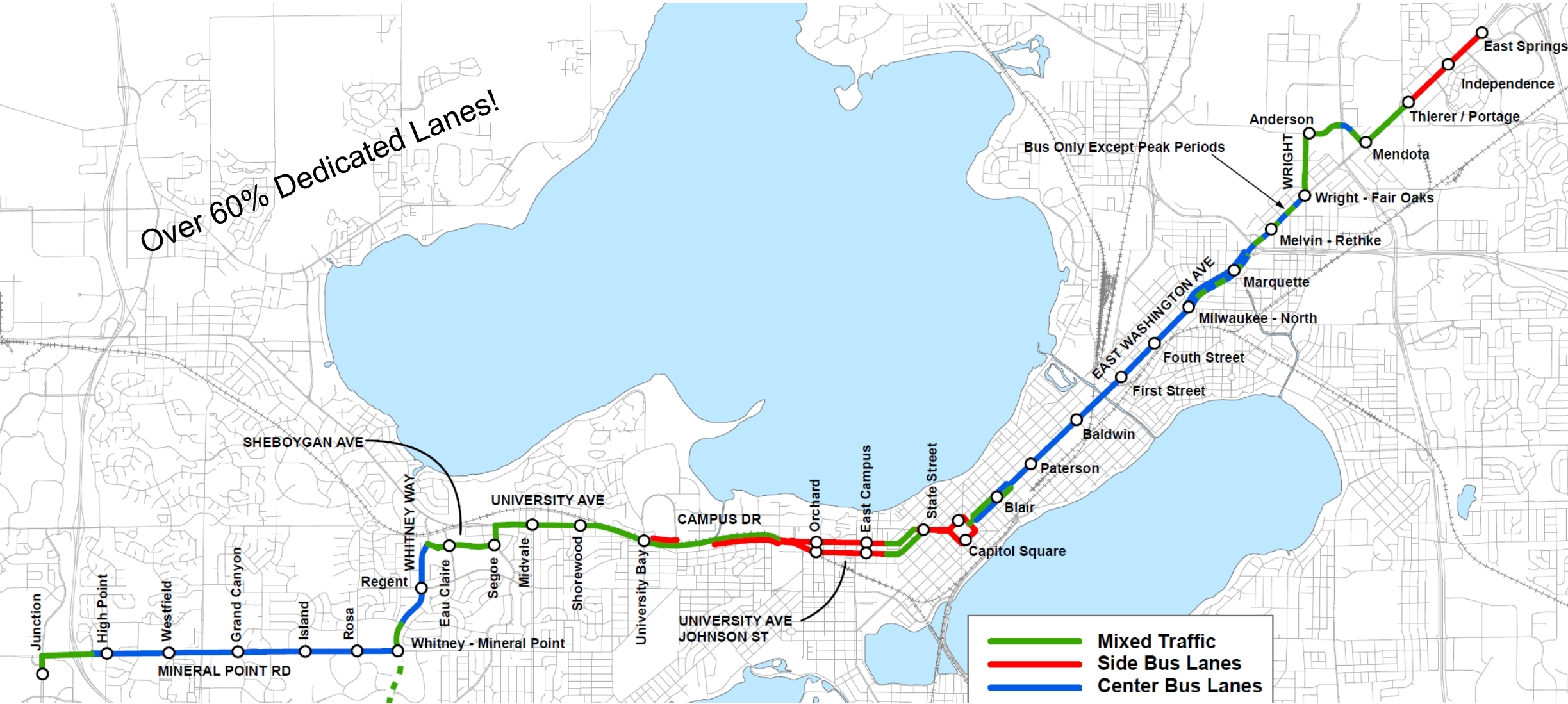

# City of Madison BRT Stations – high quality experience

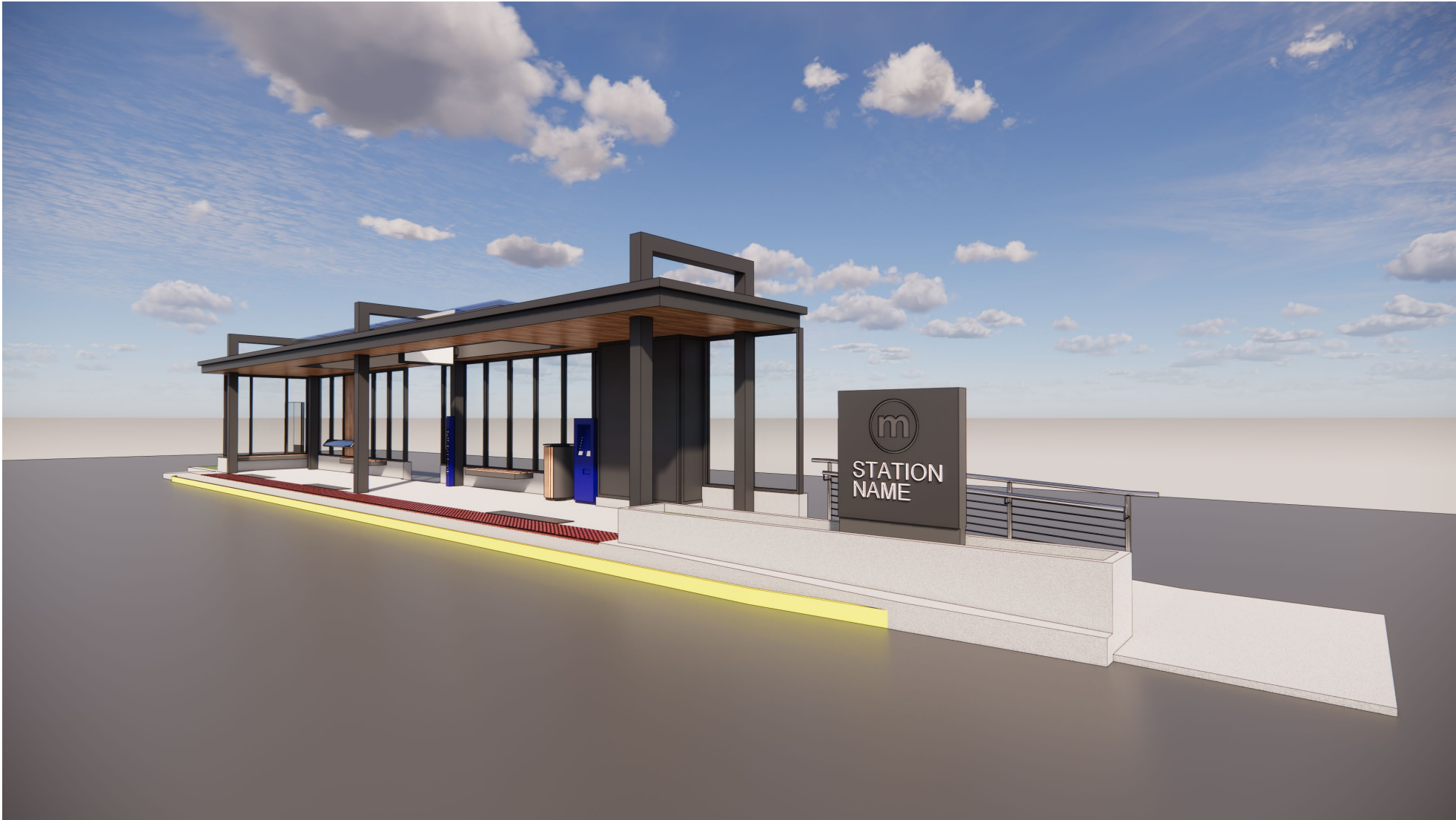

# City of Madison BRT

Madison Bus Rapid Transit Overview

Org Chart

Routes/Running Way & Stations

Station Locations

Western Segment (Mineral Point, Whitney Way, Sheboygan, University Ave)

Eastern Segment (Downtown & East Washington)

Traffic Components

Peak Hour Bus Lane

Left Turn Lanes

Communications (Transit Signal Priority)





Mineral Point Road  
Widened Sidewalk

Renderings are conceptual





Whitney Way  
Regent Street

Renderings are conceptual





Sheboygan Avenue  
Eau Claire Avenue

Renderings are conceptual



# City of Madison BRT

Madison Bus Rapid Transit Overview

Org Chart

Routes/Running Way & Stations

Station Locations

Western Segment (Mineral Point, Whitney Way, Sheboygan, University Ave)

Eastern Segment (Downtown & East Washington)

Traffic Components

Peak Hour Bus Lane

Left Turn Lanes

Communications (Transit Signal Priority)





State Street  
Eastbound

Renderings are conceptual





Capitol Square  
Eastbound

Renderings are conceptual





East Washington  
4<sup>th</sup> Street

Renderings are conceptual





East Washington  
Independence Lane

Renderings are conceptual



# City of Madison BRT Running Way

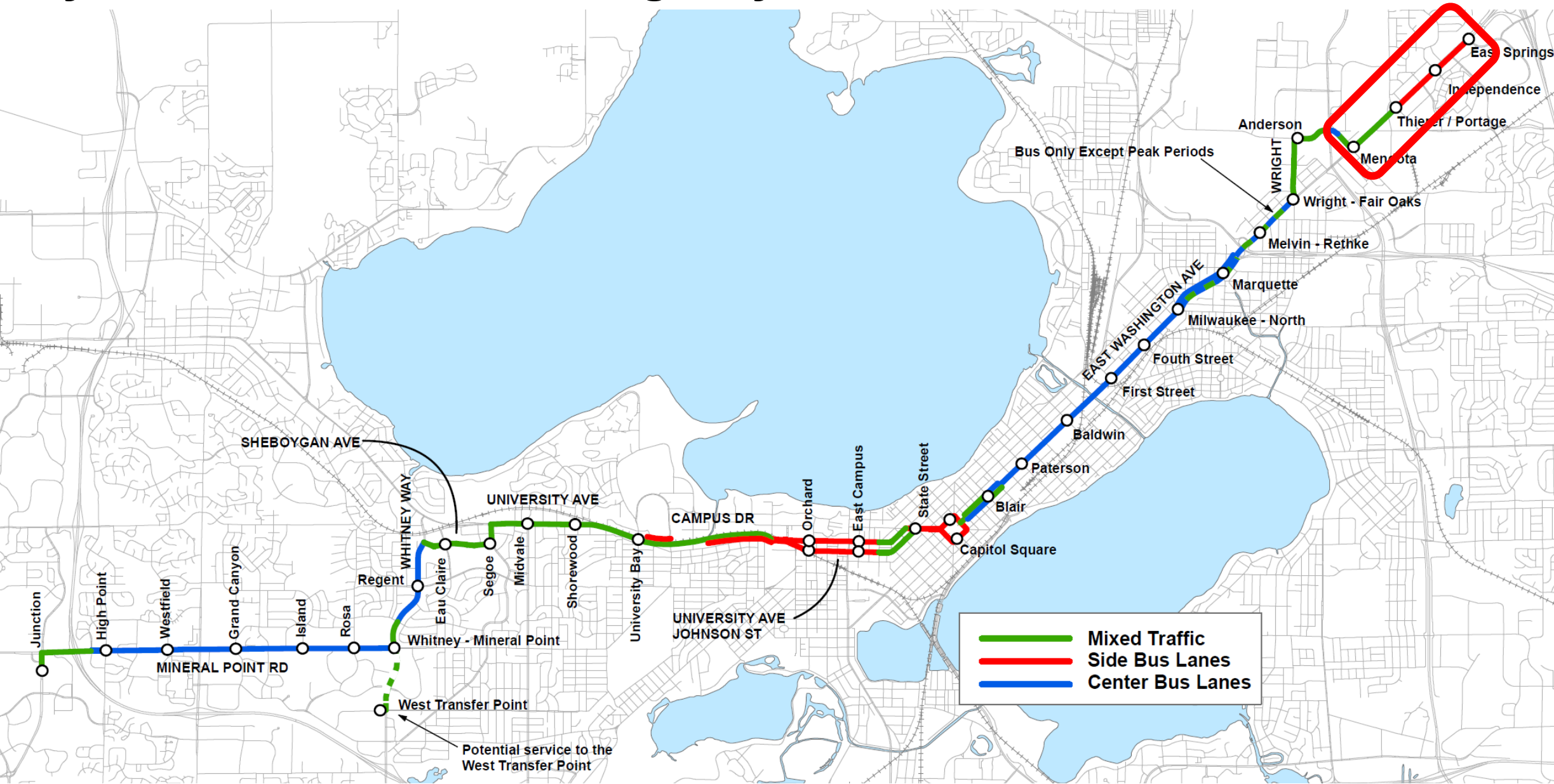

# City of Madison BRT Running Way

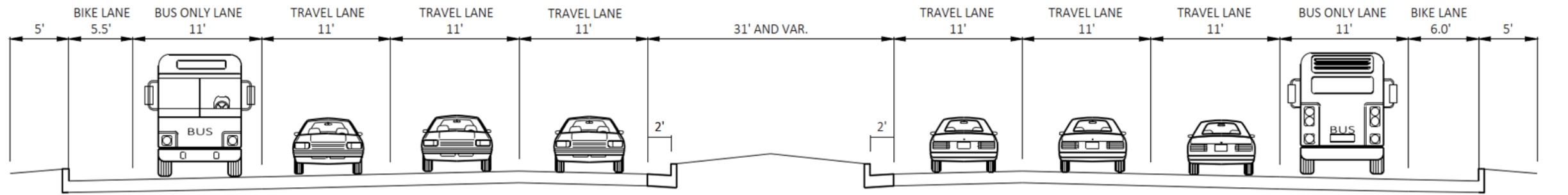
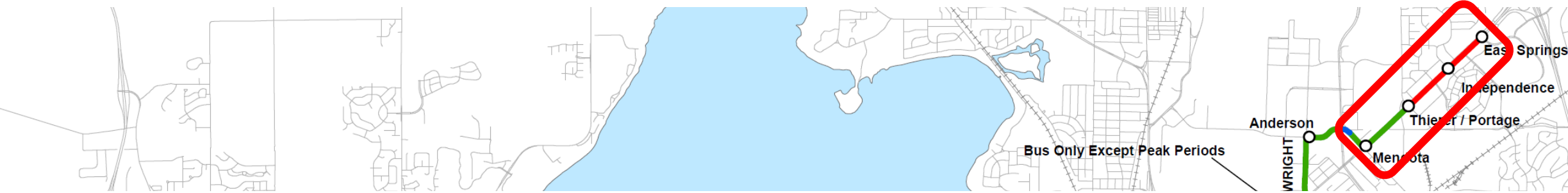

FINISHED TYPICAL SECTION  
EAST WASHINGTON AVENUE (EAST OF THIERER RD)  
LOOKING EAST



# Near-Side Stop with Bike Channel at Sidewalk Level

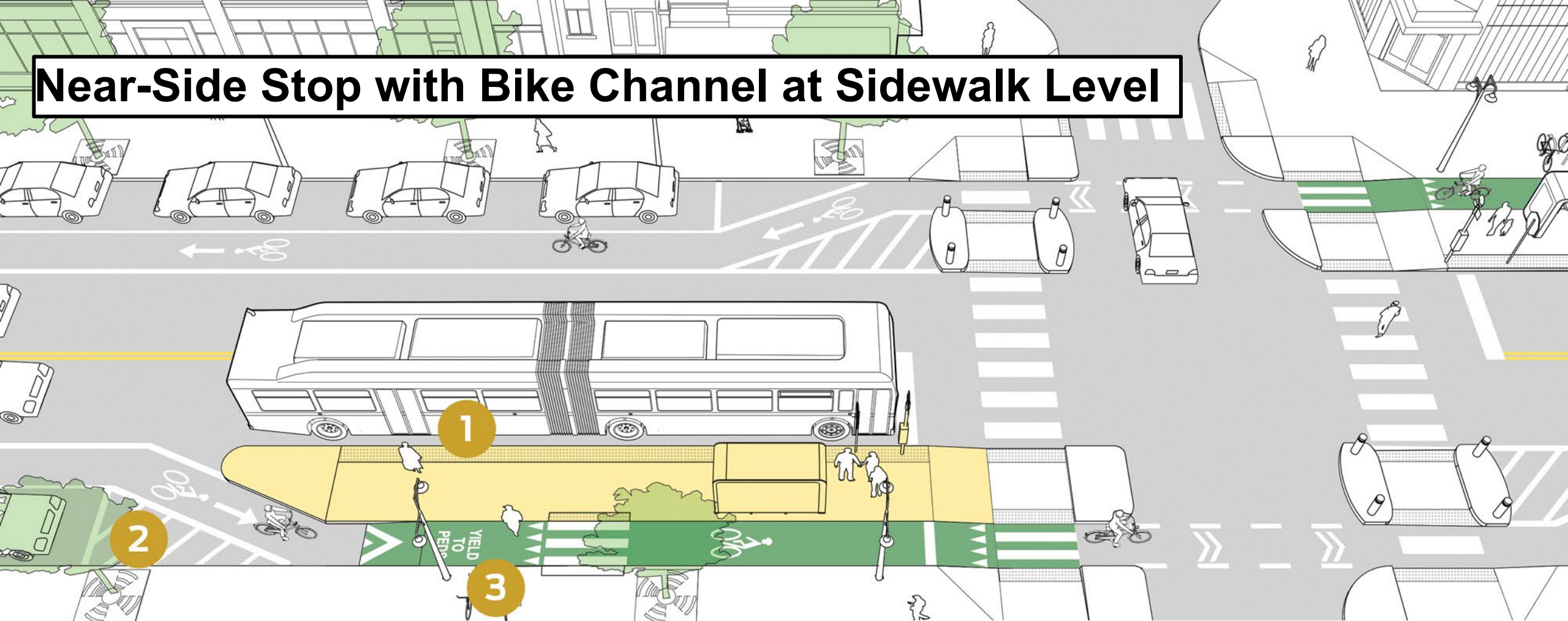

- 1 Boarding Platform
- 2 Bicycle Lane
- 3 Pedestrian Crossing

Source: <https://nacto.org/publication/transit-street-design-guide/stations-stops/stop-configurations/side-boarding-island-stop/>



RAMP UP TO  
SIDEWALK  
ELEVATION

EAST WASHINGTON AVE

RAMP DOWN TO  
STREET ELEVATION

STATION

RAMP UP  
TO STATION  
ELEVATION

RAMP DOWN FROM  
STATION ELEVATION

MENDOTA ST

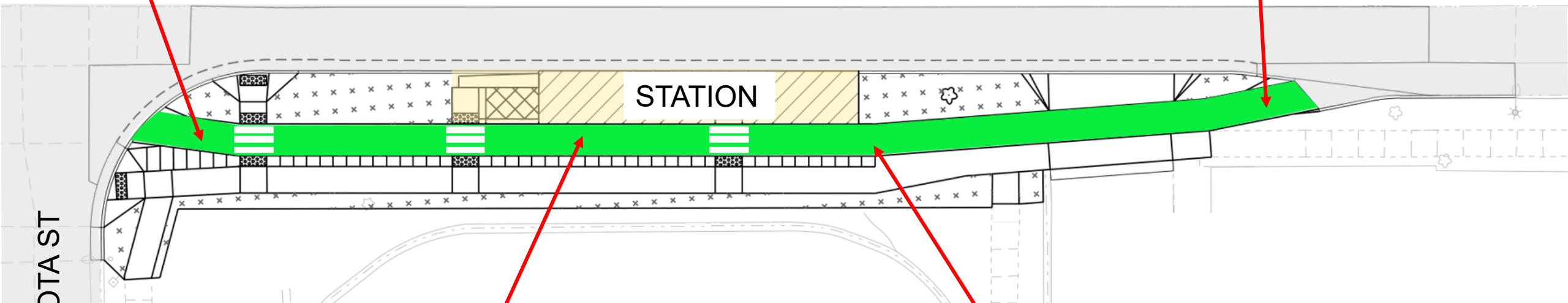

# City of Madison BRT

Madison Bus Rapid Transit Overview

Org Chart

Routes/Running Way & Stations

Station Locations

Western Segment (Mineral Point, Whitney Way, Sheboygan, University Ave)

Eastern Segment (Downtown & East Washington)

**Traffic Components**

**Peak Hour Bus Lane**

Left Turn Lanes

Communications (Transit Signal Priority)

# City of Madison BRT Running Way

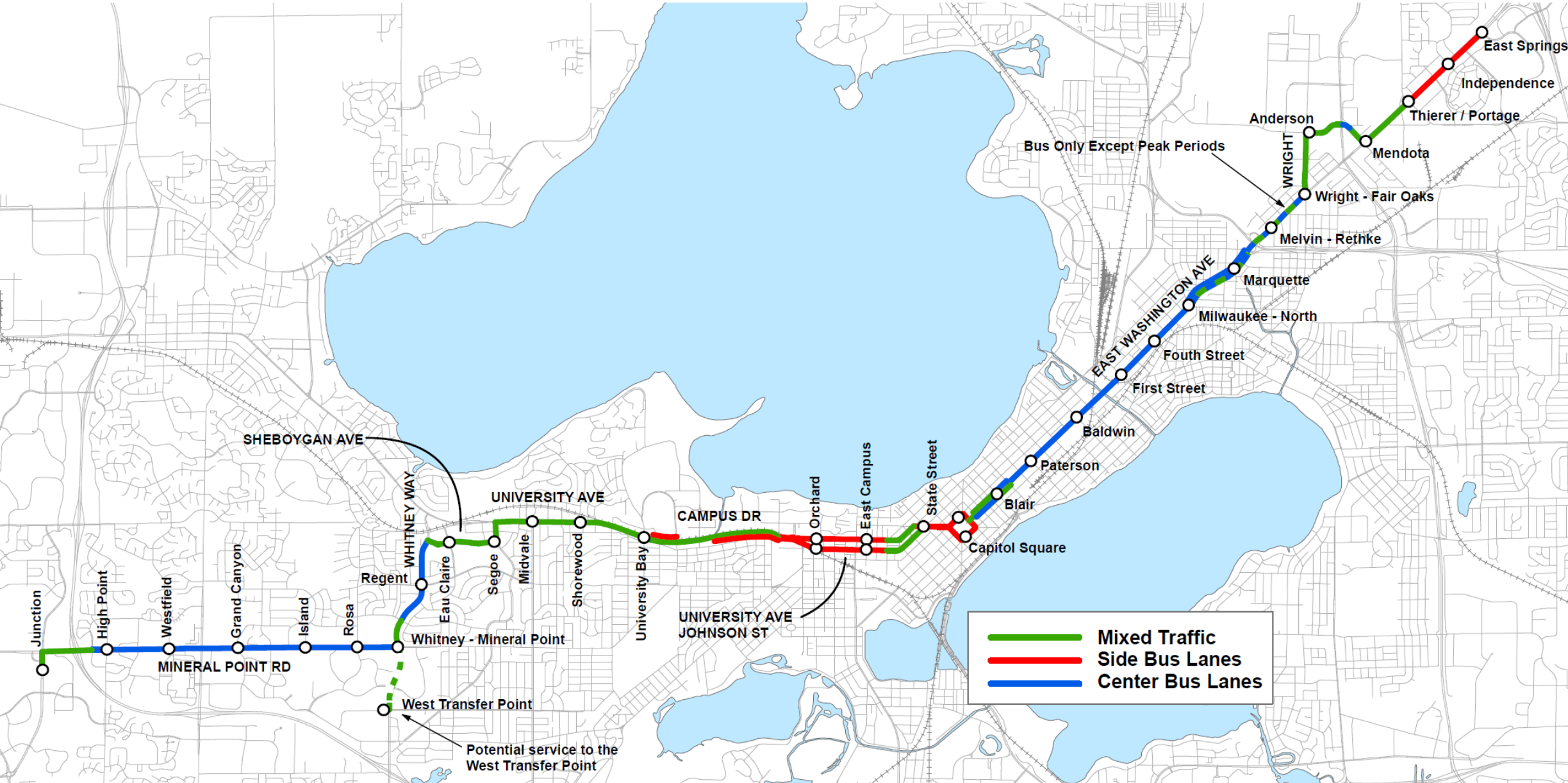

# City of Madison BRT Running Way

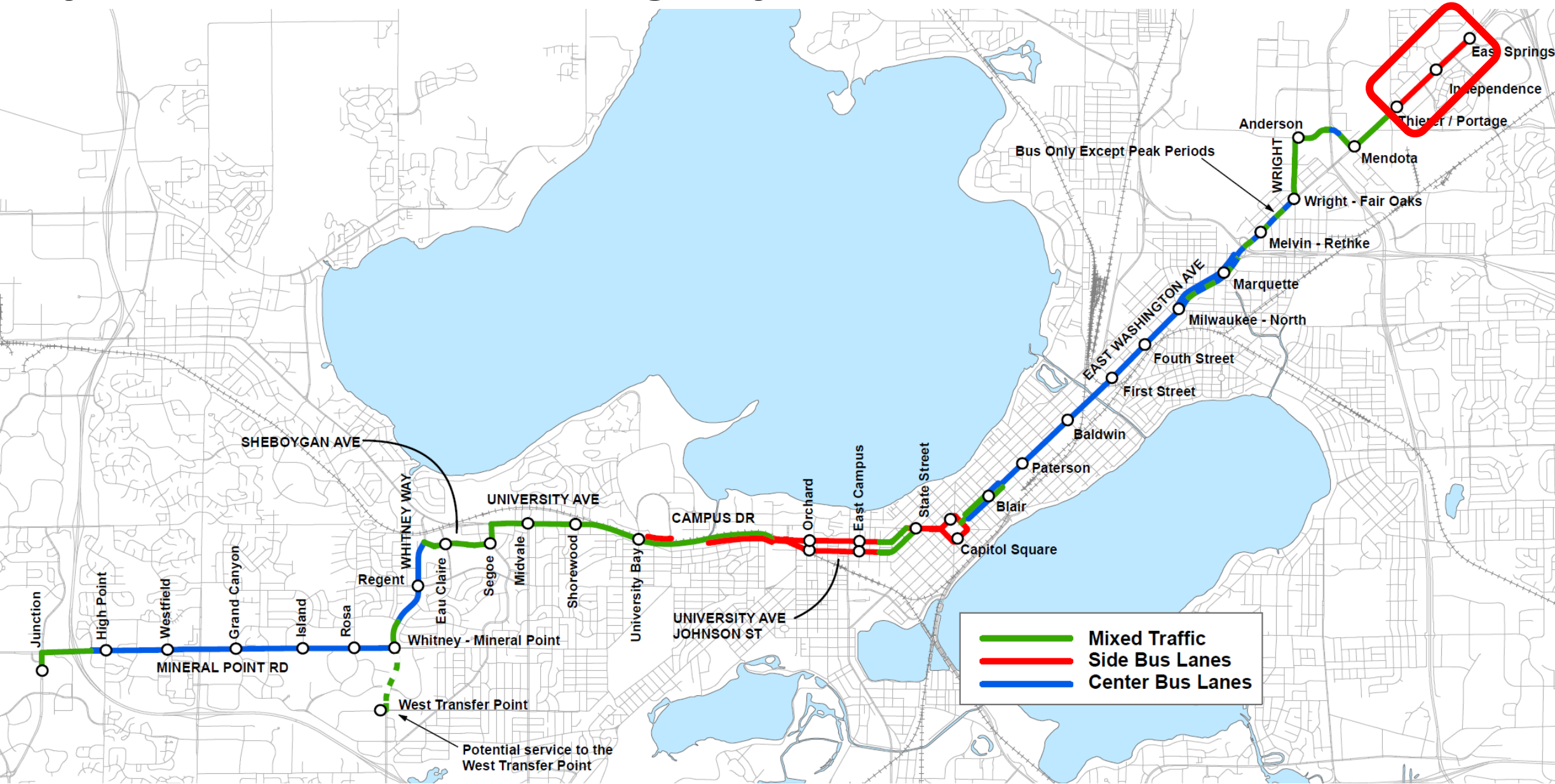



# City of Madison BRT Running Way



# City of Madison BRT Running Way

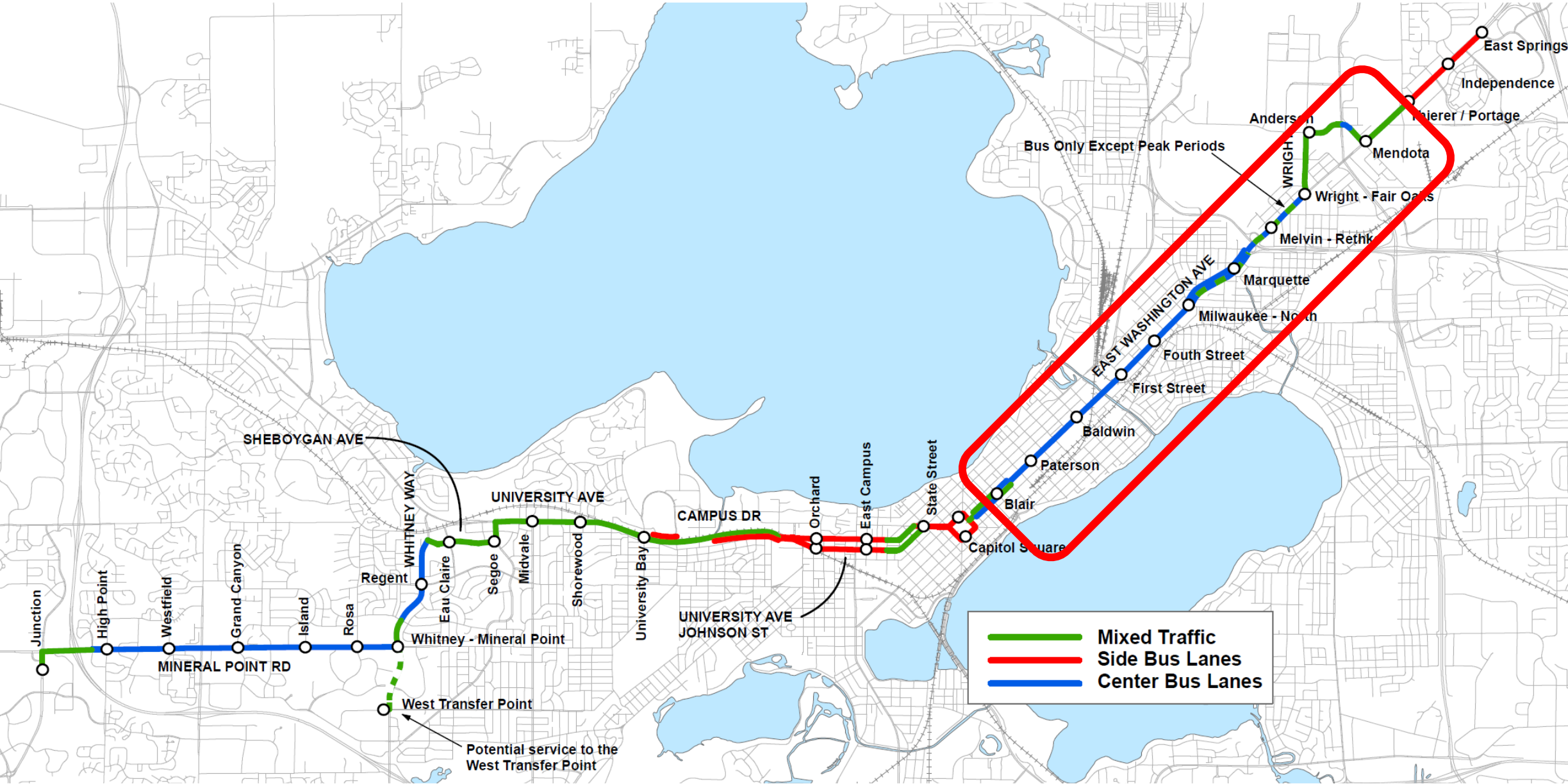

**NO PARKING 6-9 AM**

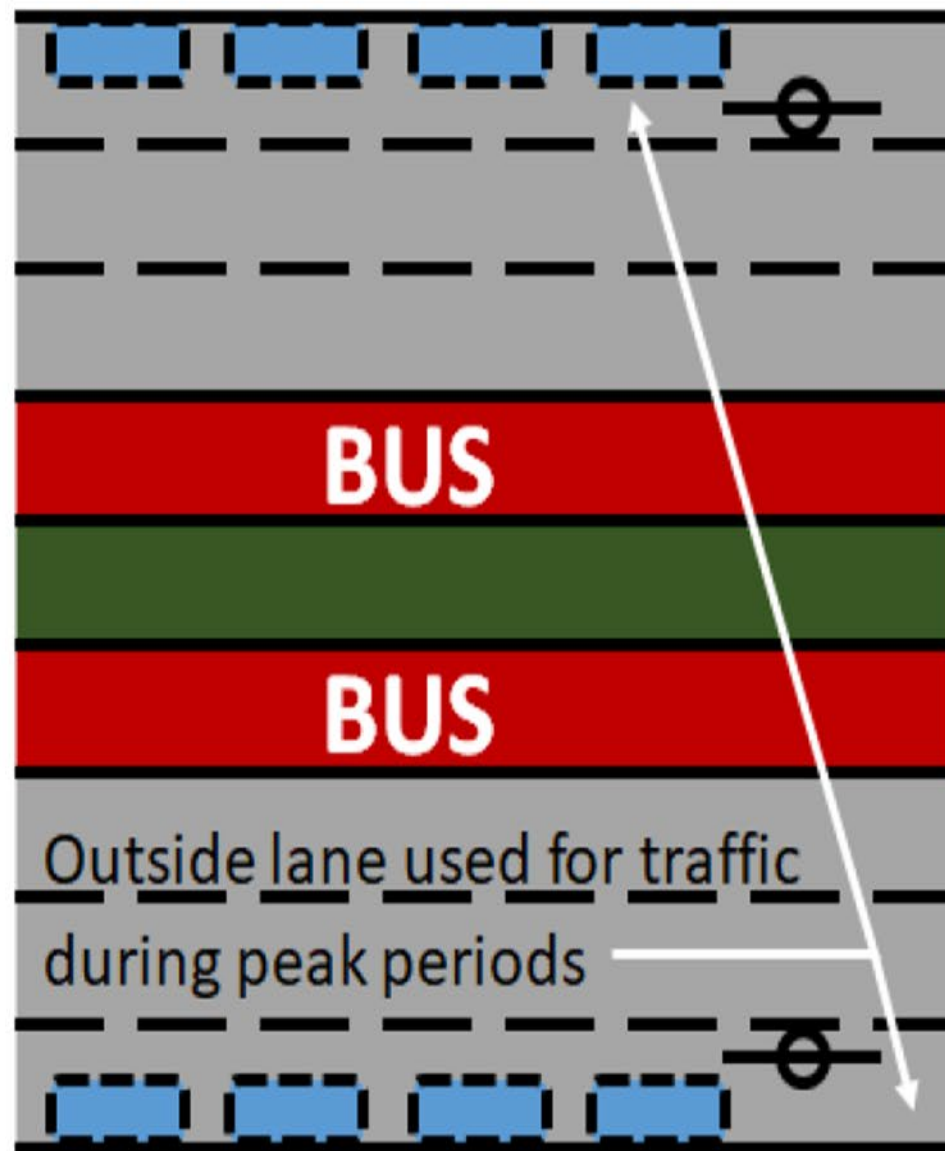

**NO PARKING 3-6 PM**

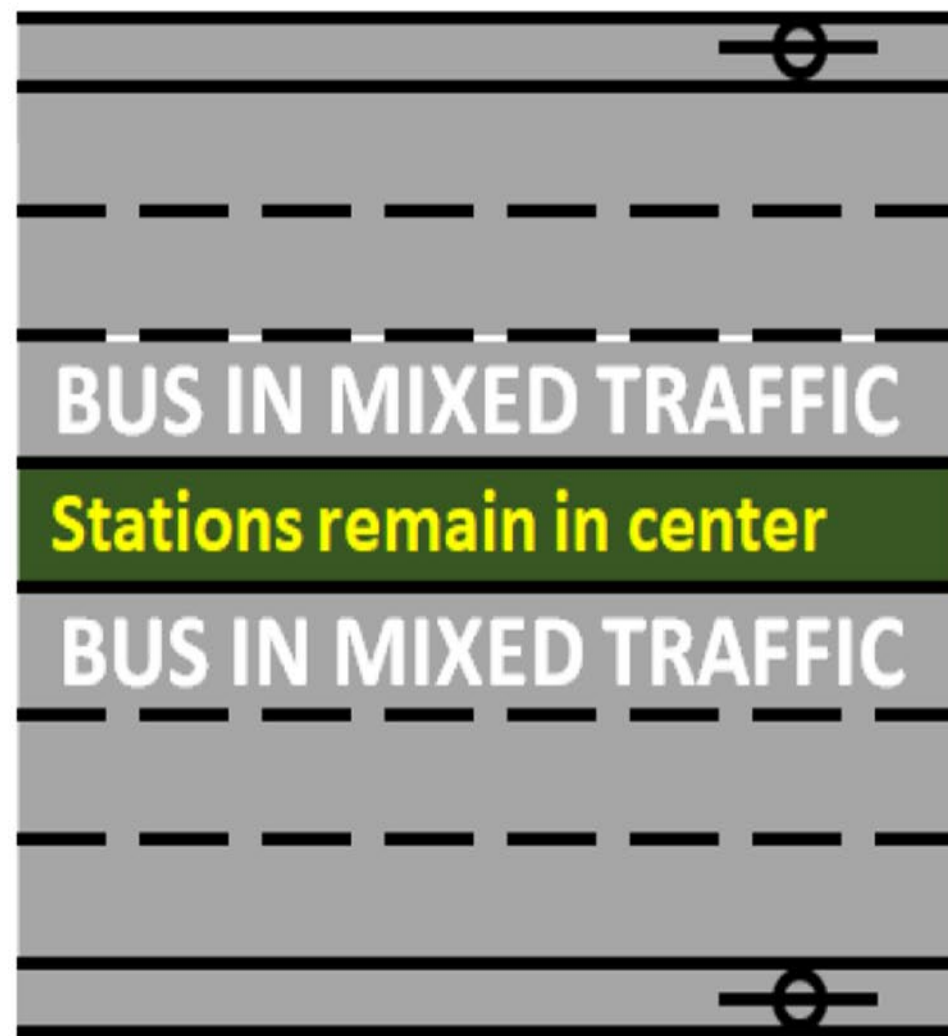



# City of Madison BRT Running Way

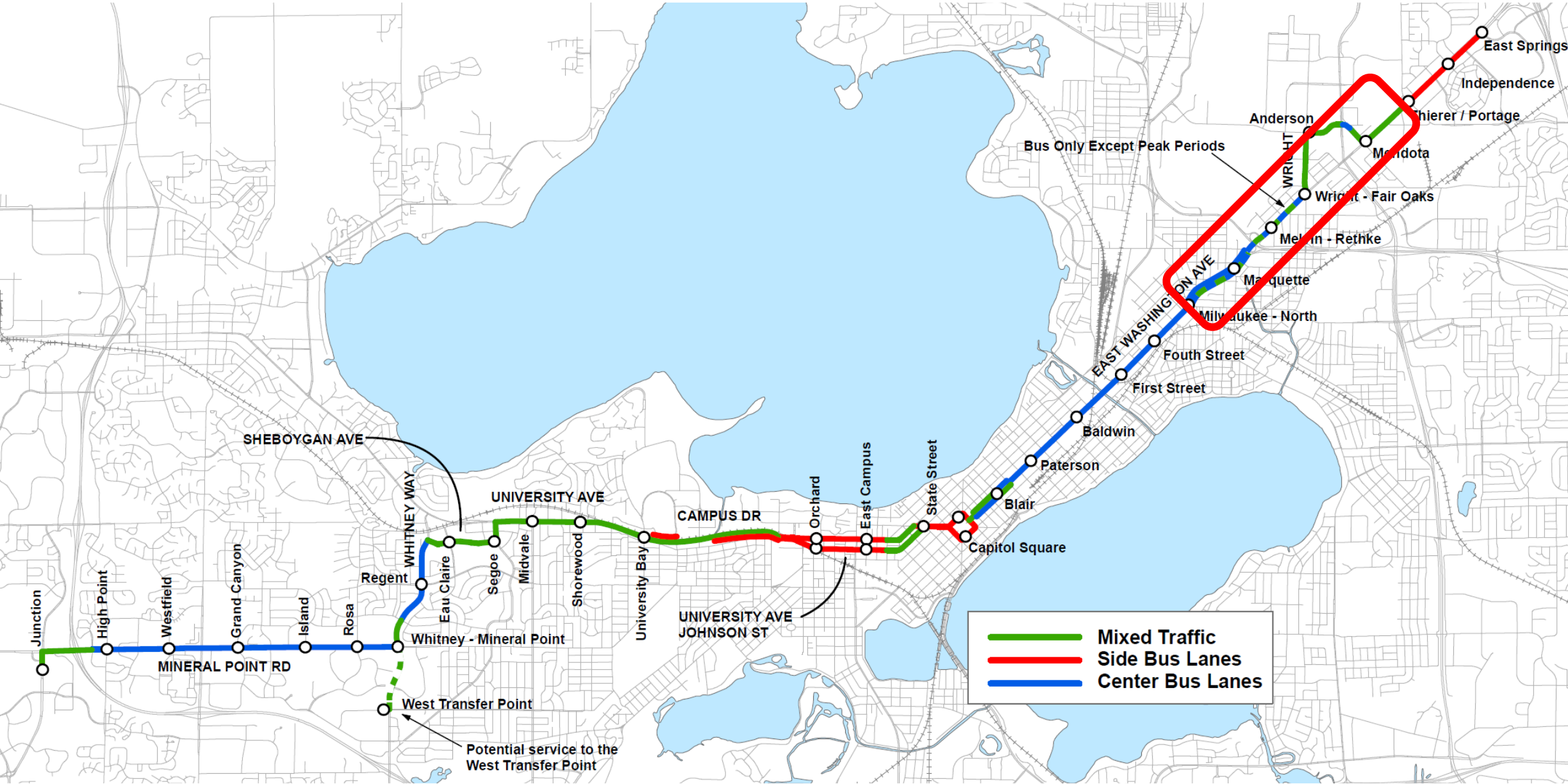



# City of Madison BRT Running Way

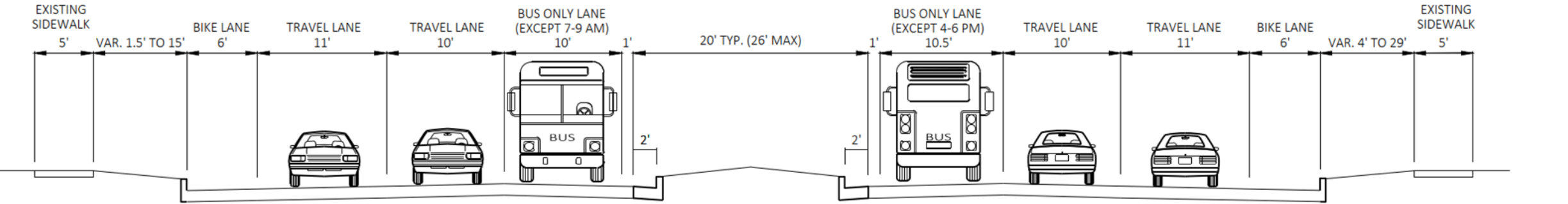
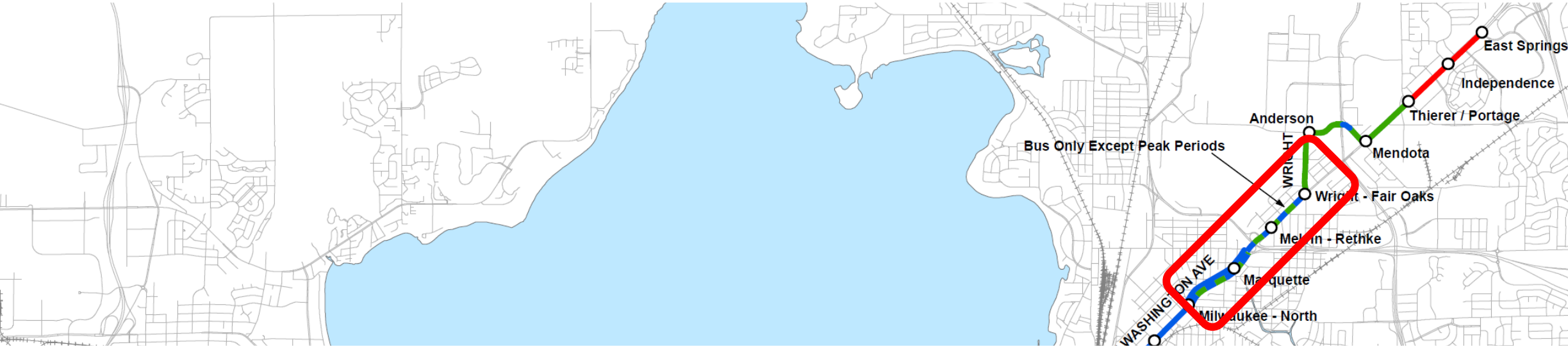

**FINISHED TYPICAL SECTION**  
EAST WASHINGTON AVENUE (E. OF MELVIN COURT)  
LOOKING EAST



# Center Running Station – Travel Lanes

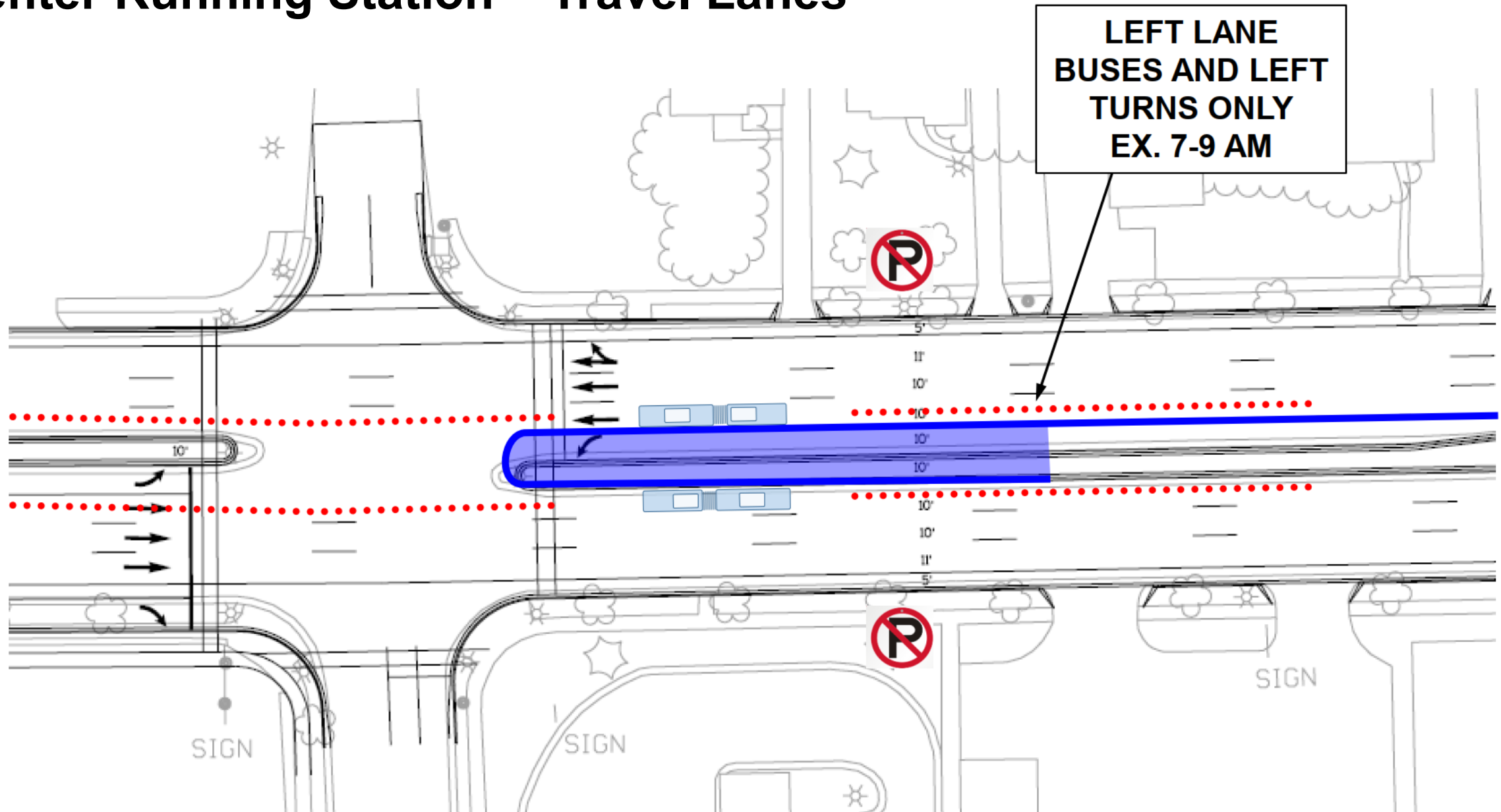

# City of Madison BRT Running Way

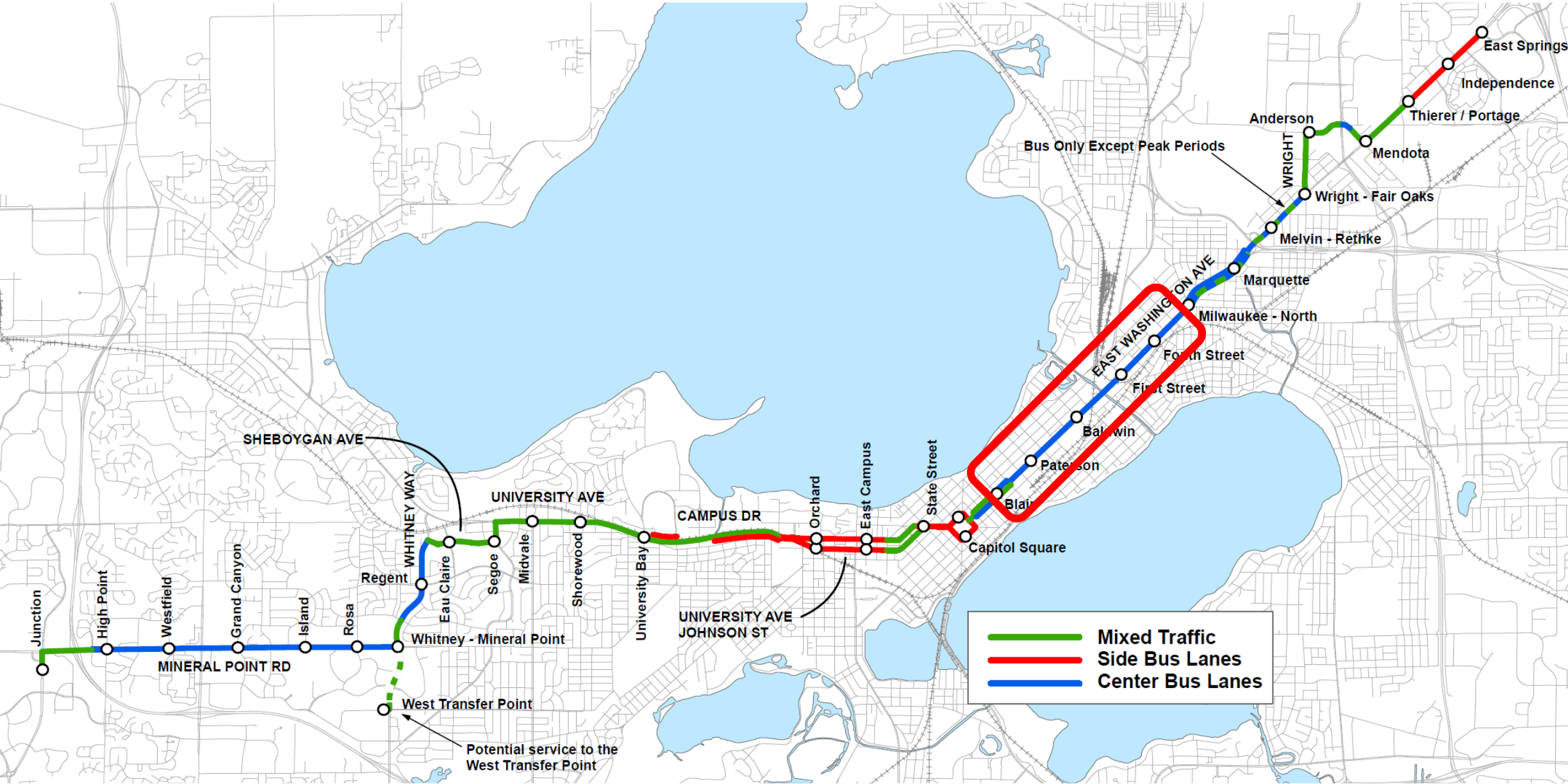

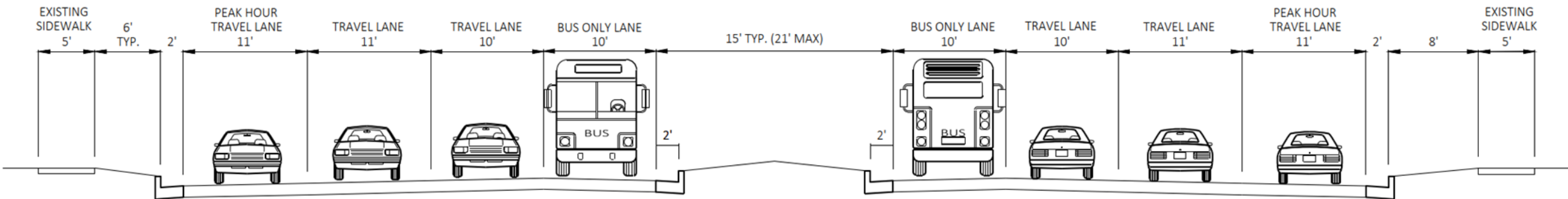

**FINISHED TYPICAL SECTION**  
 EAST WASHINGTON AVENUE (E. OF LIVINGSTON STREET)  
 LOOKING EAST

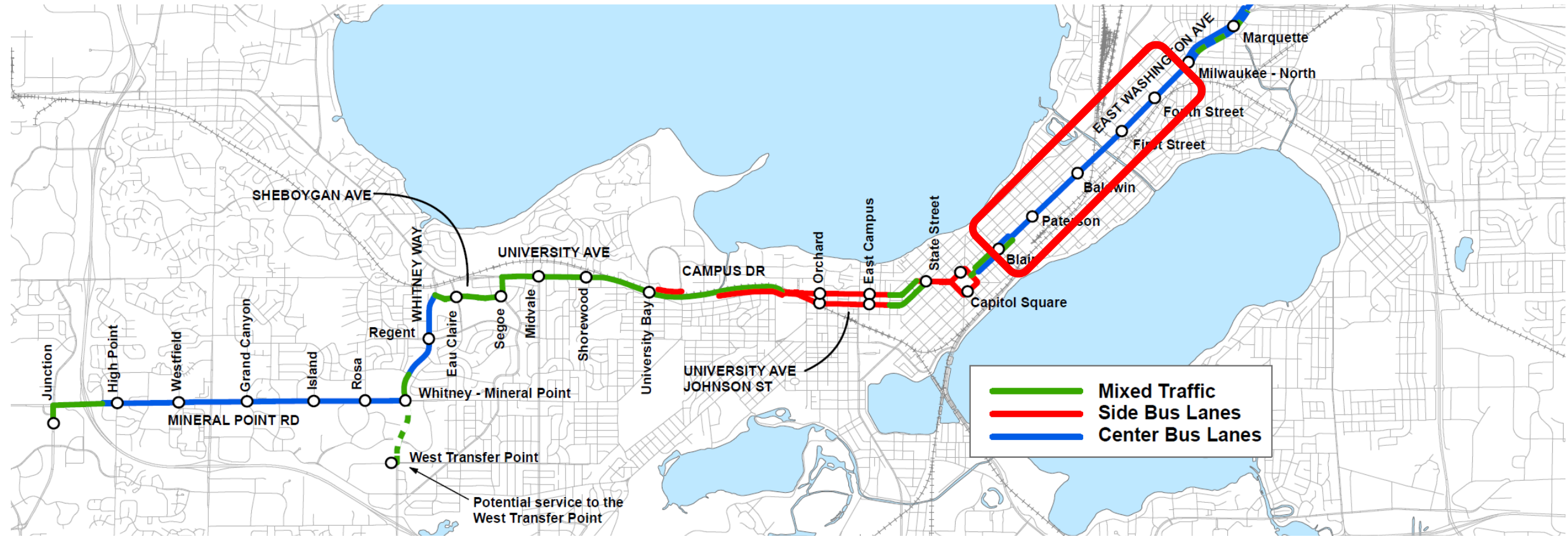



# Center Running Station – Travel Lanes

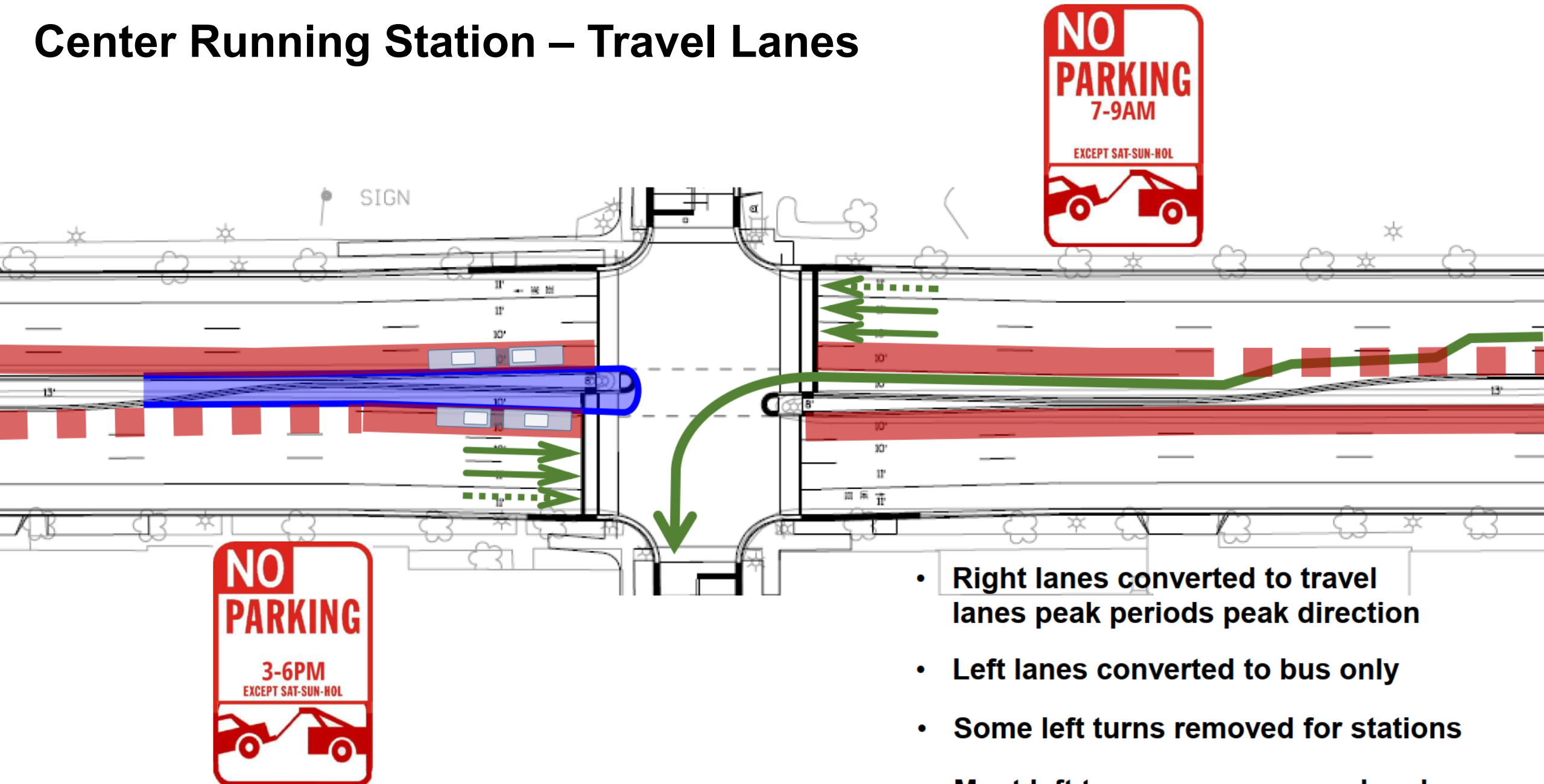

# City of Madison BRT

Madison Bus Rapid Transit Overview

Org Chart

Routes/Running Way & Stations

Station Locations

Western Segment (Mineral Point, Whitney Way, Sheboygan, University Ave)

Eastern Segment (Downtown & East Washington)

**Traffic Components**

Peak Hour Bus Lane

**Left Turn Lanes**

Communications (Transit Signal Priority)

# Center Running Station – Left Turn Removal

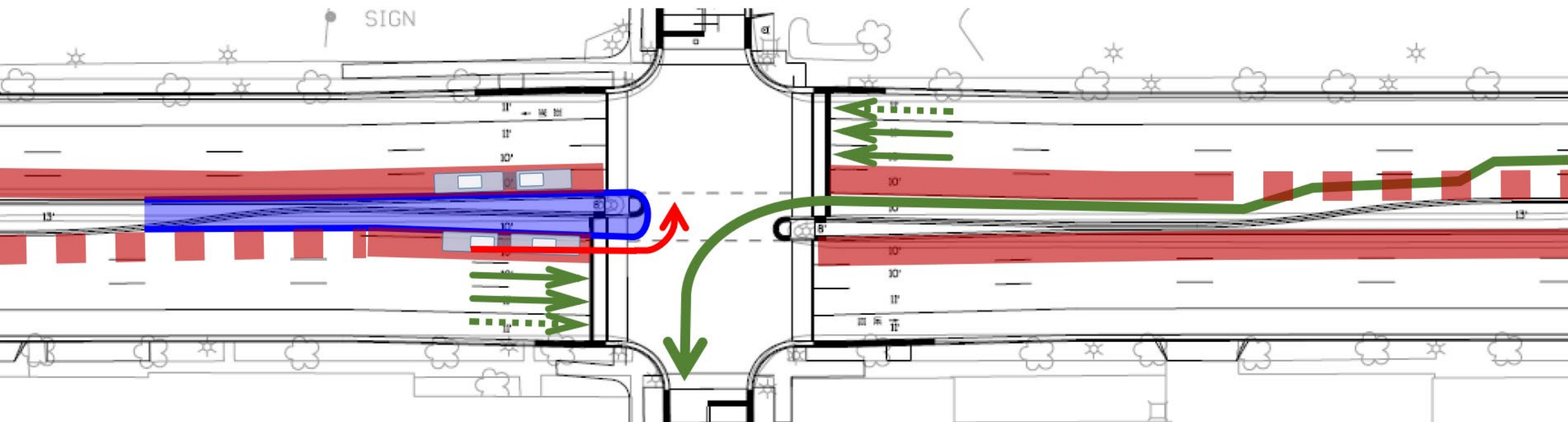

# East Washington – Left Turn Removals





# City of Madison BRT

Madison Bus Rapid Transit Overview

Org Chart

Routes/Running Way & Stations

Station Locations

Western Segment (Mineral Point, Whitney Way, Sheboygan, University Ave)

Eastern Segment (Downtown & East Washington)

Traffic Components

Peak Hour Bus Lane

Left Turn Lanes

Communications (Transit Signal Priority)

# Transit Signal Priority

- Bus Signal Heads
- System Connectivity
- Key Locations

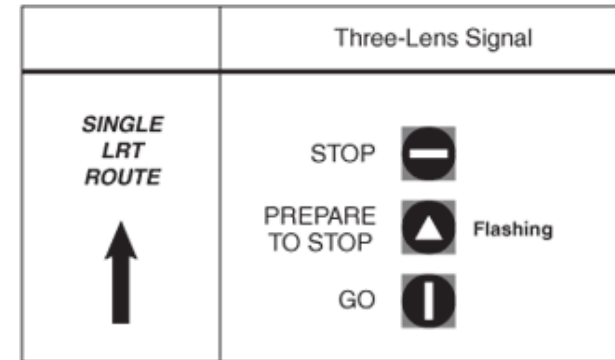

Source: MUTCD ([https://mutcd.fhwa.dot.gov/html/2009/part8/fig8c\\_03\\_longdesc.htm](https://mutcd.fhwa.dot.gov/html/2009/part8/fig8c_03_longdesc.htm))

# Transit Signal Priority

- Bus Signal Heads
- System Connectivity
- Key Locations

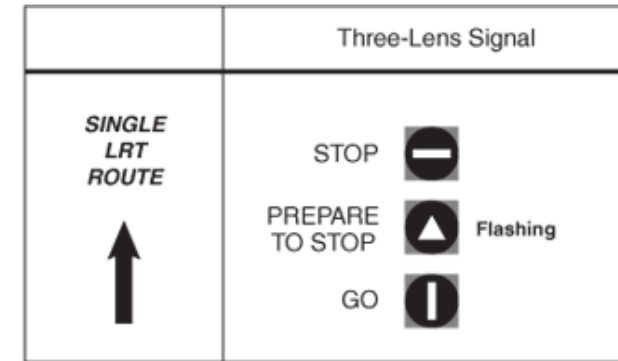

Source: MUTCD ([https://mutcd.fhwa.dot.gov/html/2009/part8/fig8c\\_03\\_longdesc.htm](https://mutcd.fhwa.dot.gov/html/2009/part8/fig8c_03_longdesc.htm))

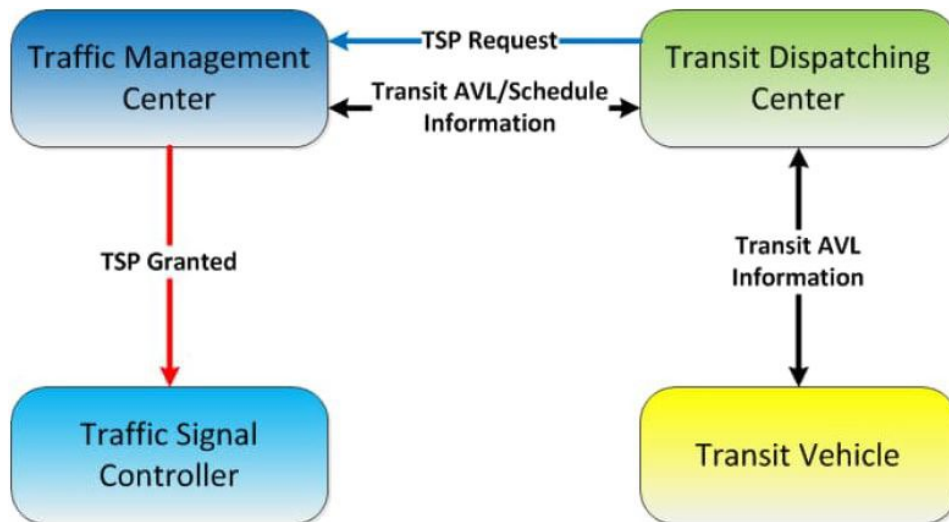

# Transit Signal Priority

- Bus Signal Heads
- System Connectivity
- Key Locations

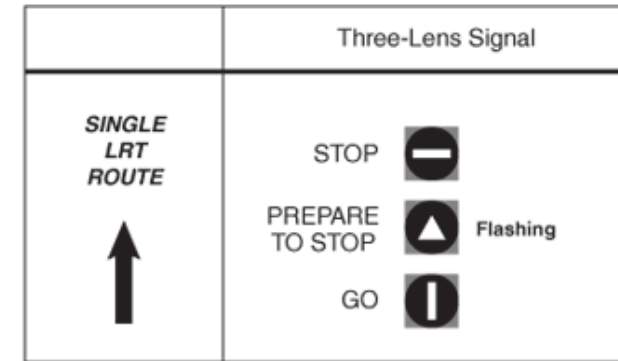
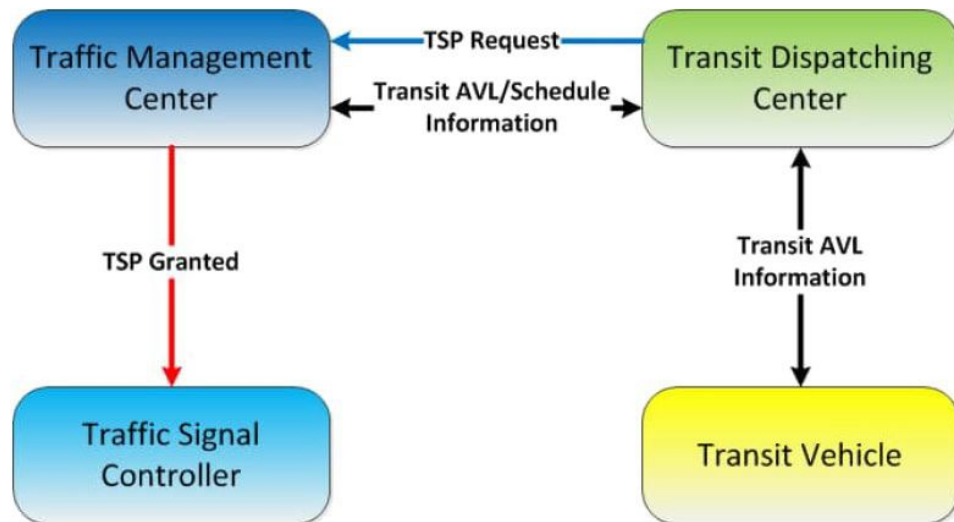

Source: MUTCD ([https://mutcd.fhwa.dot.gov/html/2009/part8/fig8c\\_03\\_longdesc.htm](https://mutcd.fhwa.dot.gov/html/2009/part8/fig8c_03_longdesc.htm))

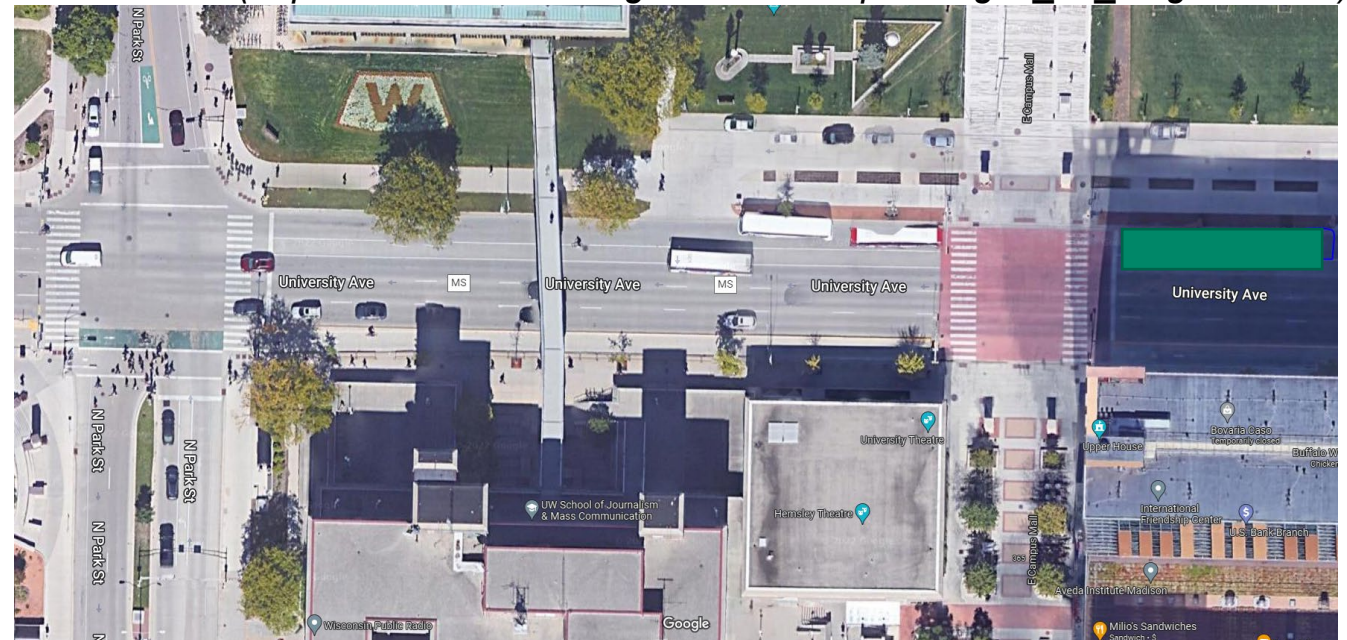

Source: Google Maps

# Transit Signal Priority

- Bus Signal Heads
- System Connectivity
- Key Locations

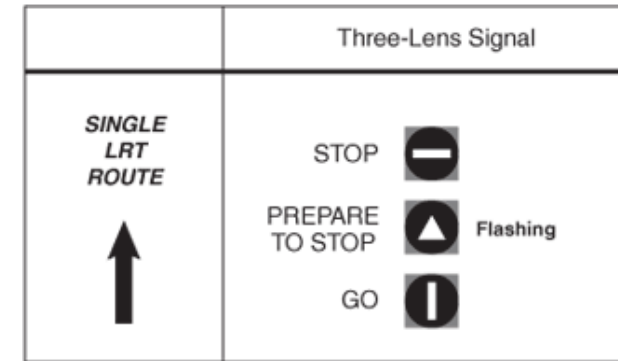
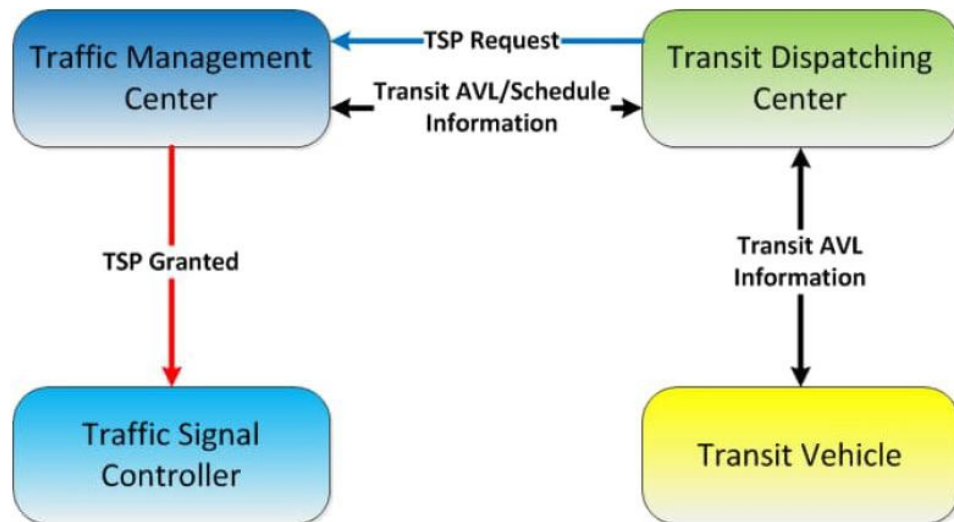

Source: MUTCD ([https://mutcd.fhwa.dot.gov/html/2009/part8/fig8c\\_03\\_longdesc.htm](https://mutcd.fhwa.dot.gov/html/2009/part8/fig8c_03_longdesc.htm))



Source: Google Maps



# Open Discussion

## Additional Resources

City Website: <https://www.cityofmadison.com/metro/routes-schedules/bus-rapid-transit>



**Thank you.**